

# APEX<sup>®</sup>

ULTREX<sup>®</sup> SIDING SYSTEM

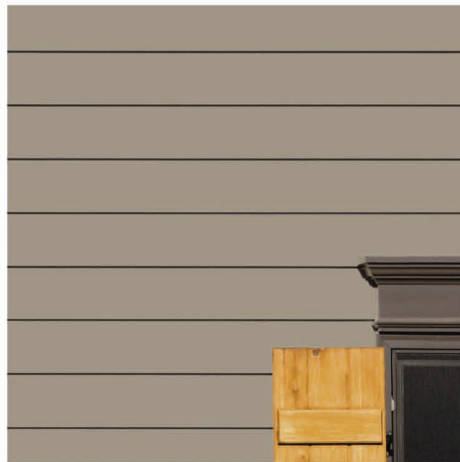
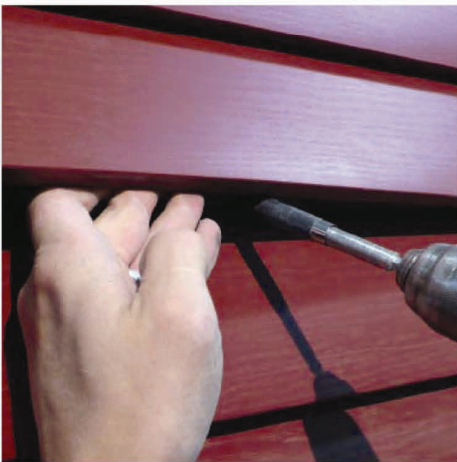
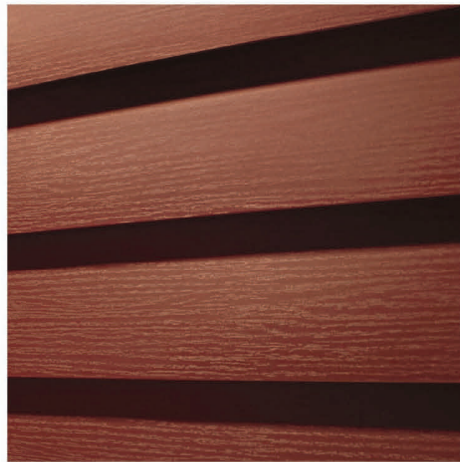

REPAIR INSTRUCTIONS

**IMPORTANT:** Read through instructions thoroughly before beginning to replace any damaged material. Minor damage can be fixed with a fiberglass repair kit and color matched paint (see page 8-9). Contact your distributor for more information on color matched paint.

## Tools Required



|  |                                    |                                       |
|--|------------------------------------|---------------------------------------|
| Tape Measure                           | Metal Clippers                     | Screw Bit Set With Extensions         |
| Hammer and/or Pry Bar                  | Corrosion Resistant Fasteners      | Car Duster                            |
| 6" Mini Grinder<br>7-1/4" Circular Saw | Cordless Drill                     | Safety Glasses                        |
| Seam Flashing                          | Water Management Clips             | Metal Cutters (Knipex is Recommended) |
| Weather Barrier Tape (building codes)  | Continuous Rim Diamond Tile Blades |                                       |

## Ensuring System Performance

1. Proper cutting of APEX® siding and trim components requires the use of a continuous rim diamond tile blade.
2. Fasteners must be corrosion resistant, penetrate the stud at least 1" and hard nailed securely to the structure.
3. The entire piece of damaged siding must be removed from seam to seam.
4. Siding and starter strip must be fastened through factory applied water management clips to maintain water management plane.
5. Ensure the back of the siding at seams is wiped free from dust before flashing tape is applied to ensure adhesion.

## Removal of Damaged Siding

### Damaged Piece

- Using a hand saw equipped with a continuous rim diamond tile blade, cut the entire length of the damaged piece of siding as close to the top as possible.



Proper cutting of APEX siding and trim components requires the use of a continuous rim diamond tile blade.

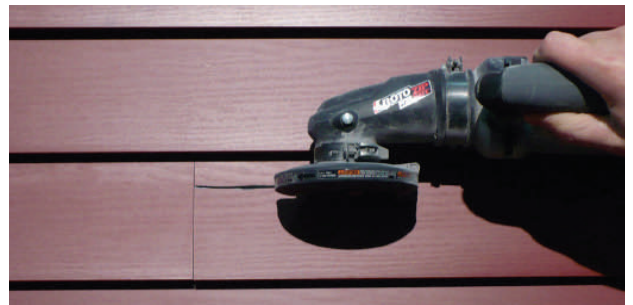

- Once the piece is cut, remove the bottom of the damaged part.



You must remove the entire piece of damaged siding from seam to seam.



**NOTE:** Cut through any double sided tape if necessary. Be sure not to damage the house wrap underneath. Any damage that occurs to the house wrap during the replacement process must be repaired before the replacement piece is installed.

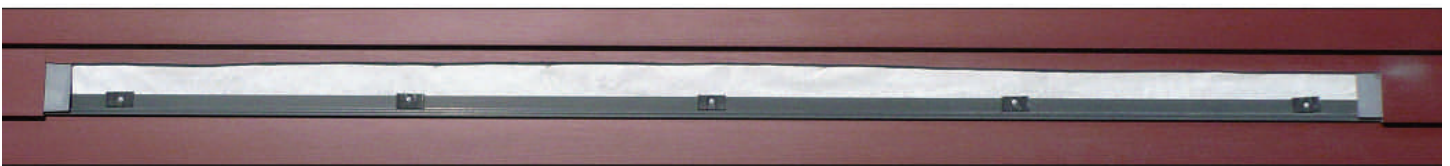

## Removal of Damaged Siding

- Working from left to right, carefully pry out each nail that holds the top of the damaged piece in place.

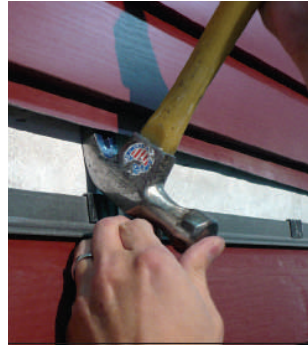

- If nails cannot be completely removed, pull remaining piece out with pliers or cut each one and push the remainder of the nail point in.
- Remove seam flashing and as much flashing tape as possible using a utility knife.

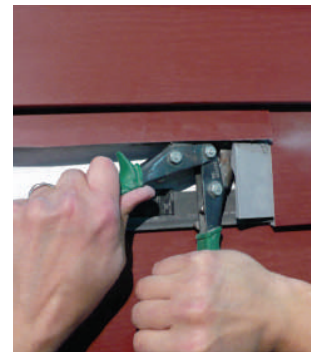



## Removal of Damaged Siding

- Push up on remaining piece of siding to release the interlock.
- Remove the remainder of the damaged piece.

**NOTE:** It may be easier to remove the damaged piece by cutting it into smaller sections and removing.



# Installing the Replacement Siding

- Measure and cut the replacement part to length.
- Cut through entire interlock on each end only of the replacement piece.
- Cut the interlock guide along the entire piece and remove.
- Install new seam flashing behind seams of siding that will butt joints with the replacement piece.

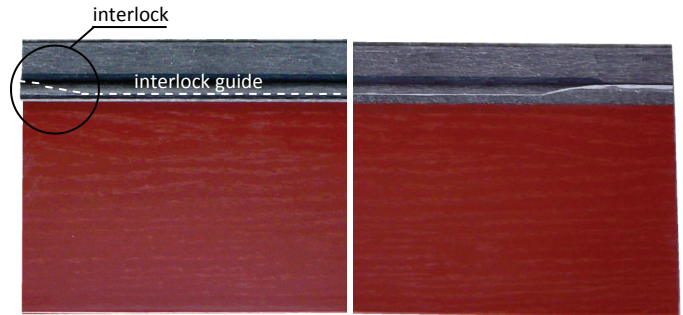

Ensure the back of the siding at seams is wiped free from dust before flashing tape is applied to ensure adhesion.

**NOTE:** Do not place seam flashing over any remaining flashing tape.

- Install water management clips to line up with studs.

**NOTE:** If you are fastening with screws place a water management clip on each side of where the screw will be fastened into the stud as shown below.

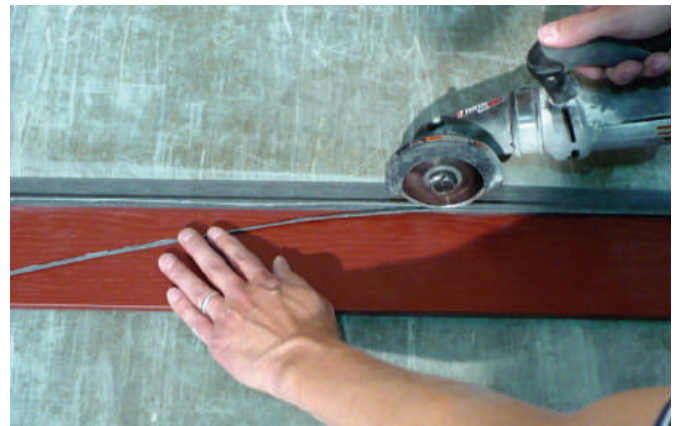

# Installing the Replacement Siding

- Install the replacement piece of siding and ensure it is interlocked with the part below it.
- Lift the bottom of the siding section above the replacement piece and fasten through water management clips.



Fasteners must be corrosion resistant, penetrate the stud at least 1" and hard nailed securely to the structure.



Siding and starter strip must be fastened through factory applied water management clips to maintain water management plane.

**NOTE:** If you are fastening with screws, ensure a water management clip is installed on each side of where the screw will be fastened into the stud.





## Installing the Replacement Siding

- Once all screws have been fastened, move from one end to the other ensuring the replacement piece is interlocked with the piece above it.
- Double check interlock across entire piece and ensure reveal height is correct.
- Wipe any dust from the siding with a soft cloth or duster.





# Moderate Repairs

Minor to moderate damages to APEX components can be fixed with a fiberglass repair kit and color matched paint. Contact your distributor for more information about color matched paint.

**NOTE:** If the component being repaired must remain structurally sound, it may be best to replace the piece. If it is necessary to replace APEX trim, the adjacent siding must be removed first as siding and trim are integrated.

You will need:

- fiberglass repair compound
  - putty knife
  - utility knife
  - handheld grinder
  - 120-150 grit sandpaper
  - 320-400 grit sandpaper
  - foam brush
  - exterior grade primer
  - exterior grade acrylic latex paint (consult your APEX dealer)
  - masking tape
  - protective plastic
- Using a utility knife, carefully remove all loose pieces of fiberglass and/or dust or debris.
  - If necessary, create a stable surface for the fiberglass compound by fastening scrap pieces of fiberglass, coil, or wire mesh.
  - Using a grinder, make indentations to the surface that will receive fiberglass compound. This will help ensure adhesion. Remove any dust or debris.

**NOTE:** Marring the surface with a grinder is not necessary when using wire mesh.



## Moderate Repairs

- Apply the fiberglass compound according to manufacturer's directions and allow to completely dry.
- Once surface is dry, sand to a smooth finish using 120-150 grit sandpaper. Finish by polishing with 320- 400 grit sandpaper.
- To ensure a properly blended finish with the repaired section, lightly sand surrounding area with 320-400 grit sandpaper to remove the factory finish.
- Cover surrounding areas with plastic to protect from paint.
- Prime the repaired surface and surrounding area with an exterior grade primer according to manufacturer's instructions. Allow to dry.
- When the primer has dried and cured, apply the exterior grade acrylic latex paint and blend into the surrounding area. It may require additional coats to achieve desired color. Consult the paint manufacturer's instructions.

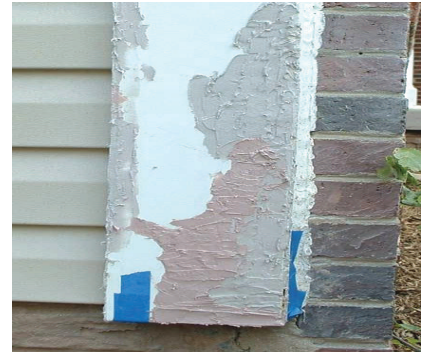

If you have questions that are not addressed in this information please contact your local APEX dealer or visit [www.apexsiding.com](http://www.apexsiding.com).